

Neodymium pot magnet is a simple mounting magnet system with neo magnets encased in a durable steel cup. This makes a magnetic shielding area and then focused all magnetic force on one side of magnet.

The pull force of pot magnet is bigger than normal permanent magnet without steel cup and can hold heavier objects. It is one of very important mounting magnets and can be used for many installations.

**Types of Cup Magnets**

Most of pot magnets are around. They are also known as round base magnets. We produce

**Metal Pin Magnets**



Model	D (mm)	d (mm)	H (mm)	h (mm)	Weight (g)	Hold A4 on whiteboard	Remarks
D12*16	12	9	16	4	9.6	12 pieces	
D16*20	16	11	20	5	16	16 pieces	
D20*25	20	13	25	7	30	19 pieces	
D25*30	25	18	30	7	53	23 pieces	
D32*42	32	24	42	9	103	8 pieces	
D36*46	36	26	46	10	140	10 pieces	
D42*52	42	35	52	10	233	15 pieces	

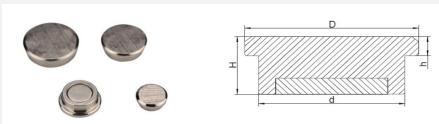

Model	D (mm)	d (mm)	H (mm)	h (mm)	Weight (g)	Hold A4 on whiteboard	Remarks
D16	16	13.2	7.2	3.2	9	11 pieces	
D22	22	18	9	3	21	13 pieces	
D25	25	21	9	3	27	15 pieces	
D30	30	27	9	3	43	17 pieces	

**Plastic Push Pins**



Model	D (mm)	H (mm)	Weight (g)	Hold A4 on whiteboard	Remarks
D12*20	12	20	3.5	18 pieces	
D19*25	19	25	7	24 pieces	
D29*38	29	38	22	30 pieces	

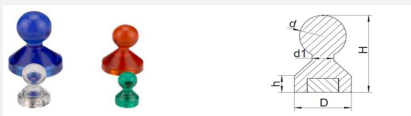

Model	D (mm)	d1 (mm)	h (mm)	Weight (g)	Hold A4 on whiteboard	
D11*17	11	9	4.2	17	3.5	11 pieces
D15*21	15	11	5	21	3.5	15 pieces
D21*26	21	13.5	5.5	26	4.5	20 pieces
D27*33	27	18	8.5	33	5.5	16 pieces

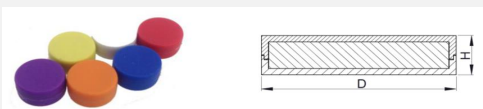

Model	D (mm)	H (mm)	Weight (g)	Hold A4 on whiteboard	Remarks
D12.7*6.35	12.7	6.35	4	11 pieces	

**Notes:**

- Steel Cup material is in A3 Steel(Q235), 304 Stainless Steel or other materials also can be customized to your request;
- The coating of the whole product can be in Zinc or NiCuNi, or other custom coating;
- The vertical holding force is tested under ideal condition by on a 10mm flat steel plate;
- The final holding force needs to be tested in actual application. The test result may be smaller if your steel is thinner, rough, coated or not flat enough;
- The neodymium pot magnet can be customized upon your request, including thread type, pull force, working temperature, coating etc.

**NINGBO HONSEN MAGNETICS CO.,LTD**

No. 90, Dongkai Road, Luotuo Industrial Area, Zhenhai District, Ningbo, Zhejiang Province  
 www.honsenmagnetics.com  
 Email: sales@honsenmagnetics.com  
 Tel: (86) 135 6789 1907