

*Neodymium pot magnet* is a simple *mounting magnet system* with neo magnets encased in a durable steel cup. This makes a magnetic shielding area and then focused all magnetic force on one side of magnet.

The pull force of pot magnet is bigger than normal permanent magnet without steel cup and can hold heavier objects. It is one of very important *mounting magnets* and can be used for many installations.

**Types of Cup Magnets**

Most of pot magnets are around. They are also known as *round base magnets*. We produce *block mounting magnets*, *channel magnets* and *rubber coated magnets* as well.

**TYPE Q**

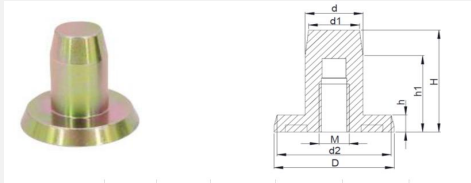

Model	D (mm)	d (mm)	d1 (mm)	d2 (mm)	H (mm)	h (mm)	h1 (mm)	M	Weight (g)
HSMN-Q40-18	40	18.1	16	35	36	6	26	M10	100
HSMN-Q40-19	40	19.3	16	35	36	6	26	M10	105

**TYPE R**

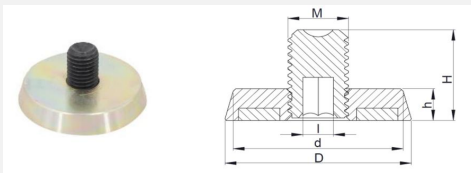

Model	D (mm)	d (mm)	H (mm)	h (mm)	l (mm)	M	Weight (g)	Attraction (Kg, N, Lbs)
HSMN-R50-M10	50	45	30	8	5	M10	130	60, 588, 132
HSMN-R50-M12	50	45	30	8	6	M12	130	60, 588, 132
HSMN-R50-M14	50	45	30	8	6	M14	135	60, 588, 132
HSMN-R50-M16	50	45	30	8	8	M16	135	60, 588, 132
HSMN-R54-M18	54	49	30	10	10	M18	165	60, 588, 132
HSMN-R54-M20	54	49	30	10	10	M20	165	60, 588, 132
HSMN-R54-M24	54	49	30	10	12	M24	170	60, 588, 132

**Notes:**

- Steel Cup material is in A3 Steel(Q235), 304 Stainless Steel or other materials also can be customized to your request;
- The coating of the whole product can be in Zinc or NiCuNi, or other custom coating;
- The vertical holding force is tested under ideal condition by on a 10mm flat steel plate;
- The final holding force needs to be tested in actual application. The test result may be smaller if your steel is thinner, rough, enough;
- The neodymium pot magnet can be customized upon your request, including thread type, pull force, working temperature,

**NINGBO HONSEN MAGNETICS CO.,LTD**

No. 90, Dongkai Road, Luotuo Industrial Area, Zhenhai District, Ningbo, Zhejiang Province

www.honsenmagnetics.com

Email: [sales@honsenmagnetics.com](mailto:sales@honsenmagnetics.com)

Tel: (86) 135 6789 1907

Attraction  
(Kg, N, Lbs)

30, 294, 66

30, 294, 66

Remarks

coated or not flat

coating etc.